

"Genuine" Parts For Eastman Chickadee® II

Model D2H and Model D2



Model D2H

Model D2

Univ. Number	Eastman Number	Description
	1C13-21	Sleeve
	1C13-26	Cord Sleeve
GE1735	4C1-149	Hex Nut
GE1828	4C2-106	Hex Nut
	10C1-45	Fan
GE1382	12C15-14	#10 Flat Washer
	12C15-89	Washer
GE1693	12C15-124	Washer For Blade Retainer
	14C1-23	Handle Grip
GE1830	17C15-133	Armature Pin
	17C15-136	Pin Label (4)
GE1831	18C6-71	Front "O" Ring Half (2)
GE1832	18C6-72	Back "O" Ring Half (2)
GE1689	20C13-99	Pan Head Screw
GE1677	21C6-3	Sharpener Bushing
GE1054	25C4-169	Knife Guard
GE1833	34C8-12	Spring
GE1678	34C10-165	Sharpener Spring
	50C7-25	Cord Clamp (D-2H)
	50C7-26	Cord Clamp (D-2)
	52C5-176	Base Switch
GE1692	53C11-112	Knife Cover Flange
	57C1-61	Switch Lever
GE1676	63C3-22	Sharpener Button
GE1836	68C3-6	Pressure Foot
	79C1-151	Plate (No. 120V)
	79C1-152	Plate (No. 230V)
	79C2-61	Caution Plate
	79C2-77	Name Plate
GE1685	79C12-276	Gear Retaining Plate
GE1327	80C1-147	Round Knife (2-1/4")
GE1328	80C1-149/2	Hex Knife (2-1/4")
GE1690	83C4-25	Knife Flange
GE1674	86C7-42	Brush Cap (2)
GE1679	87C7-43	Knife Gear
GE1839	87C7-44	Worm Gear
	90C6-42	Rear Bearing
GE1840	90C6-48	Front Bearing
	95C5-7	Allen Key
	98C4-32	On/Off Plate
GE1841	109C5-1	Tip Shear Plate
GE1683	190C1-2	Armature (120 Volt)

Univ. Number	Eastman Number	Description
	190C1-3	Armature (230 Volt)
	191C1-37	Wicking Felt
	199C1-29	Lug
	300C8-1	Rd. Head Screw (4-40 x 3/8") (2)
	300C8-9	Round Head Screw (4-40 x 3/16")
GE1574	300C12-3	Round Head Screw (8-32 x 3/8")
	301C3-1	Fil. Head Screw (2-56 x 1/2") (2)
GE1715	301C8-1	Fillister Head Screw (4-40 x 1/2")
GE1845	301C8-4	Fillister Head Screw (4-40 x 3/4")
GE1847	301C8-6	Fillister Head Screw (4-40 x 3/16")
GE1848	301C15-6	Fillister Head Screw (10-32 x 1")
GE1691	302C8-2	Flat Head Screw (4-40 x 3/4") (2)
GE1695	305C8-4	Binding Head Screw (4-40 x 1/8") (2)
GE1849	309C8-3	Socket Head Screw (4-40 x 1/8")
	523C1-91	Attachment Plug (120 Volt - Male)
	523C1-92	Attachment Plug (120 Volt - Female)
	523C1-93	Attachment Plug (230 Volt - Male)
	523C1-94	Attachment Plug (230 Volt - Female)
GE1850	523C2-25	Cord (120 Volt)
	523C2-41	Cord (230 Volt)
	523C2-46	Cord (230 Volt - Europe)
GE1851	523C2-47	Cord Assembly (120 V. - Domestic)
	523C2-48	Cord Assembly (230 V. - Domestic)
GE1203	541C1-24	Emery Wheel Assembly
GE1852	542C1-102	Armature Assembly (120 Volt)
	542C1-103	Armature Assembly (230 Volt)
GE1425	580C1-48	Switch (D-2H)
GE1682	580C1-103	Switch (D-2)
	614C1-31	Fan & Bearing
GE1854	632C1-8	Housing, Complete w/Switch Lever
GE1675	708C1-15	Brush w/Spring (2)
GE1694	726C1-17	Shear Plate w/Carbide
	831C1-4	Handle & Tube Assembly (24" Long)
	831C1-5	Handle & Tube Assembly (30" Long)
	831C1-6	Variable Length (Specify) Handle & Tube Assembly
GE1688	829C1-4	Magnet Assembly
	830C1-10	Circuit Board Assembly (230 Volt)
GE1681	830C1-11	Circuit Board Assembly (120 Volt)

Note: Number in parenthesis indicate quantity of a part required.

Model D2H and Model D2

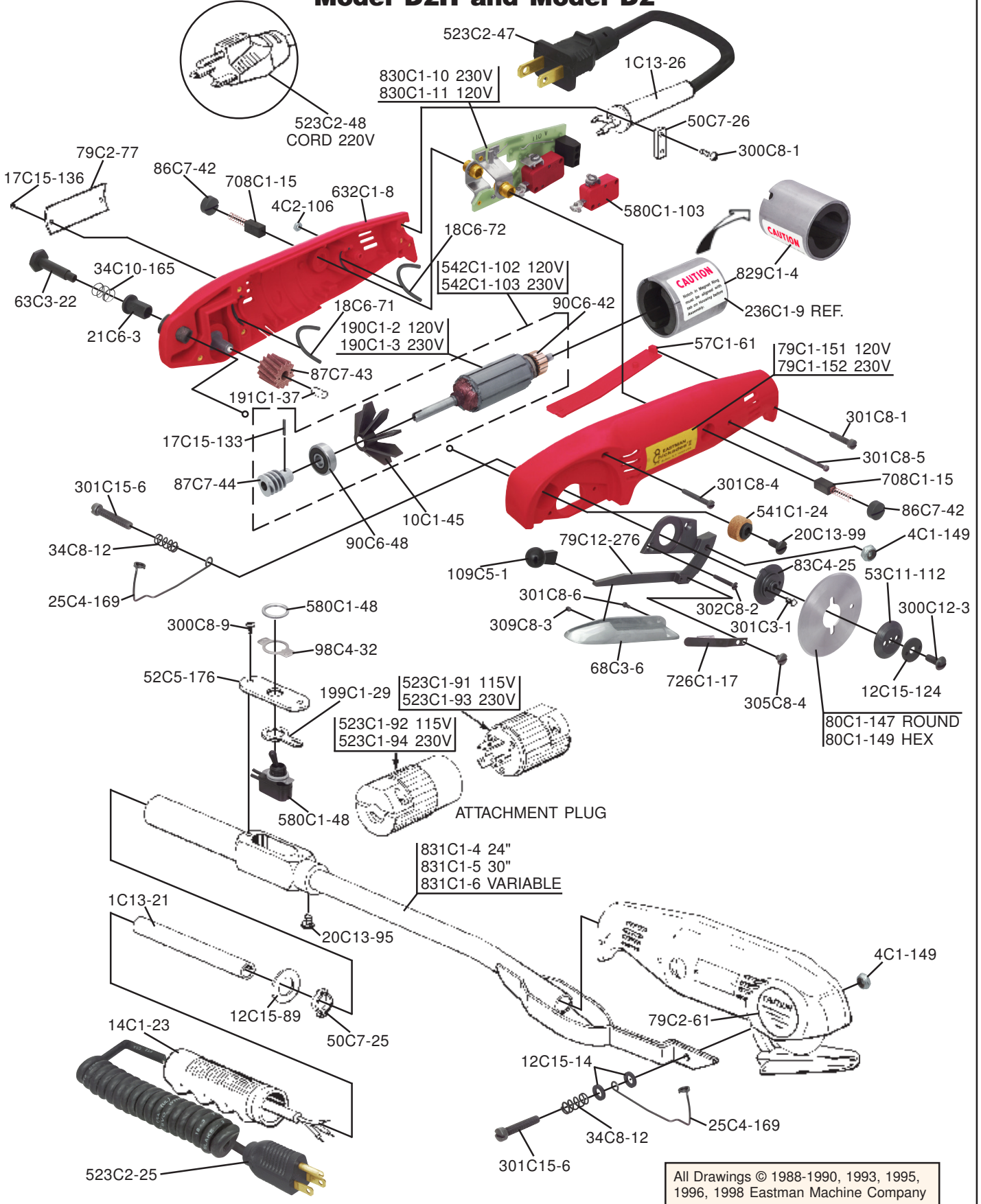

All Drawings © 1988-1990, 1993, 1995, 1996, 1998 Eastman Machine Company