

"Genuine" Parts For Eastman Straight Knives

Model 627X BRUTE Model 629X BLUE STREAK II

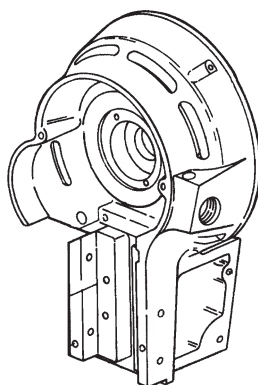

FRONT BEARING HOUSING (90C2-162) with Oiler Assembly

Univ. Number	Eastman Number	Description
	4C1-111	Operating Handle Lock Nut
GE1717	4C1-132	Crank Ball Bearing Lock Nut
GE1378	4C1-190	Lock Nut For Shaft
GE1718	4C2-91	Nut For Guide Screw (3)
GE1365	4C2-110	Stop Nut
GE1374	4C3-8	Guide Adjustment Nut (3)
GE1377	11C12-92	Shaft For Ball Bearing
GE1385	12C1-21	Shakeproof Washer (2)
GE1719	12C1-24	Knife Lock Washer
	12C10-2	Washer (3)
GE1382	12C15-14	Guide Washer (6)
GE1384	12C15-53	Connecting Rod Washer
GE1369	15C13-23	Upper Stud (2)
GE1375	15C13-34	Lower LH Mounting Stud
GE1376	15C13-39	Lower RH Mounting Stud
GE1720	17C4-6	Wrist Pin
	18C6-79	Lock Ring
	18C6-80	O-Ring
GE1386	20C5-17	Connecting Rod Clamp Screw (2)
	20C12-62	Front Housing Plug Screw
	20C12-79	Screw For Handle Bracket
GE1724	20C12-122	Guide Hold Down Screw
GE1722	24C1-3	Knife Lock Bolt
GE1362	34C10-142	Spring For Capacitor
	52C5-194	Switch Plate (Dual Speed, 3 Ph.)
	52C5-235	Switch Plate (Single Speed)
	52C5-236	Switch Plate (Dual Speed, 1 Ph.)
	53C2-111	Switch Cover
	53C6-2	Oil Tube Cover
	53C11-91	Capacitor Cover
GE1914	54C4-32	Wrist Pin Plug
GE1366	62C1-140	Handle Bracket
GE1725	71C3-18	Front Ball Bearing Retainer
GE1364	72C4-28	Oil Hole Cover
	73C7-203	Oil Tube, Clear
	73C7-204	Oiler Tube
GE1729	85C1-44	Crank (1-3/4" Stroke)
GE1728	85C1-45	Crank (1-1/2" Stroke)
GE1727	85C1-46	Crank (1-1/4" Stroke)
GE1726	85C1-52	Crank (1-1/8" Stroke)
	90C2-162	Front Bearing Housing
GE1368	90C6-38	Front Ball Bearing
GE1582	90C6-46	Sealed Crank Ball Bearing
	91C4-25	Rivet Crosshead (2)
	141C1-46	Gauge, Clear

Univ. Number	Eastman Number	Description
GE1457	191C1-21	Crosshead Felt Pad
GE1730	191C1-38	Wrist Pin Felt Pad
	191C1-42	Oil Felt Wicking, Long
	191C1-43	Oil Felt Wicking, Short
	191C1-45	Oil Felt Wicking (.187" x .44")
	201C1-11	Eyelet
	222C1-7	RTV Sealer
	300C3-2	Round Head Screw (2-56 x 1/8") (4)
GE1415	300C10-4	Round Head Screw (6-32 x 3/8") (2)
GE1691	302C8-2	Flat Head Screw (4-40 x 3/4")
GE1661	302C10-4	Flat Head Screw (6-32 x 5/16") (4)
GE1350	305C8-1	Binding Head Screw (4-40 x 1/4") (7)
	307C18-1	Screw
	308C12-1	Socket Head Screw (8-32 x 3/8") (3)
GE1379	308C14-1	Guide Hold Down Screw (4)
GE1732	309C15-5	Guide Adjustment Screw (3)
GE1390	525C1-4	LH & RH Guides (1-3/4" Stroke)
GE1389	525C1-5	LH & RH Guides (1-1/2" Stroke)
GE1915	525C1-1	LH & RH Guides (1-1/2" Stroke) (For Old Style 625 Model Only)
GE1181	525C1-6	LH & RH Guides (1-1/4" Stroke)
	525C1-7	LH & RH Guides (1-1/8" Stroke)
GE1733	531C1-53	Operating Handle
	531C1-76	Cushion Grip Handle
GE1381	579C2-17	Cross Head w/Lock Washer & Bolt
GE1361	580C1-100	Switch, Dual Speed (3 Phase)
GE1167	580C1-198	Switch, Single Speed (1 & 3 Phase)
GE1391	580C1-199	Switch, Dual Speed (1 Phase)
GE1215	607C1-35	Oiling Device
GE1910	607C1-31	Oiling Device - One Shot (For Old Style 627 & 629 Models Only)
GE1373	664C1-3	Connecting Rod (1-3/4" Stroke)
GE1372	664C1-4	Connecting Rod (1-1/2" Stroke)
GE1371	664C1-5	Connecting Rod (1-1/4" Stroke)
GE1370	664C1-6	Connecting Rod (1-1/8" Stroke)
GE1357	706C1-4 **	Capacitor (110 Volt)
GE1358	706C1-5 **	Capacitor (220 Volt)
	706C1-13 *	Capacitor (110 Volt)
	706C1-18 *	Capacitor (220 Volt)

* Class 627X Only

** Class 629X Only

Note: Number in parenthesis indicate quantity of a part required.

"Genuine" Parts For Eastman Straight Knives

Note: Certain 220 volt machines will use these capacitors. Please check the capacitor number on label of your machine to order.

706C1-4	110 Volt
706C1-5	220 Volt
706C1-13	110 Volt
706C1-18	220 Volt

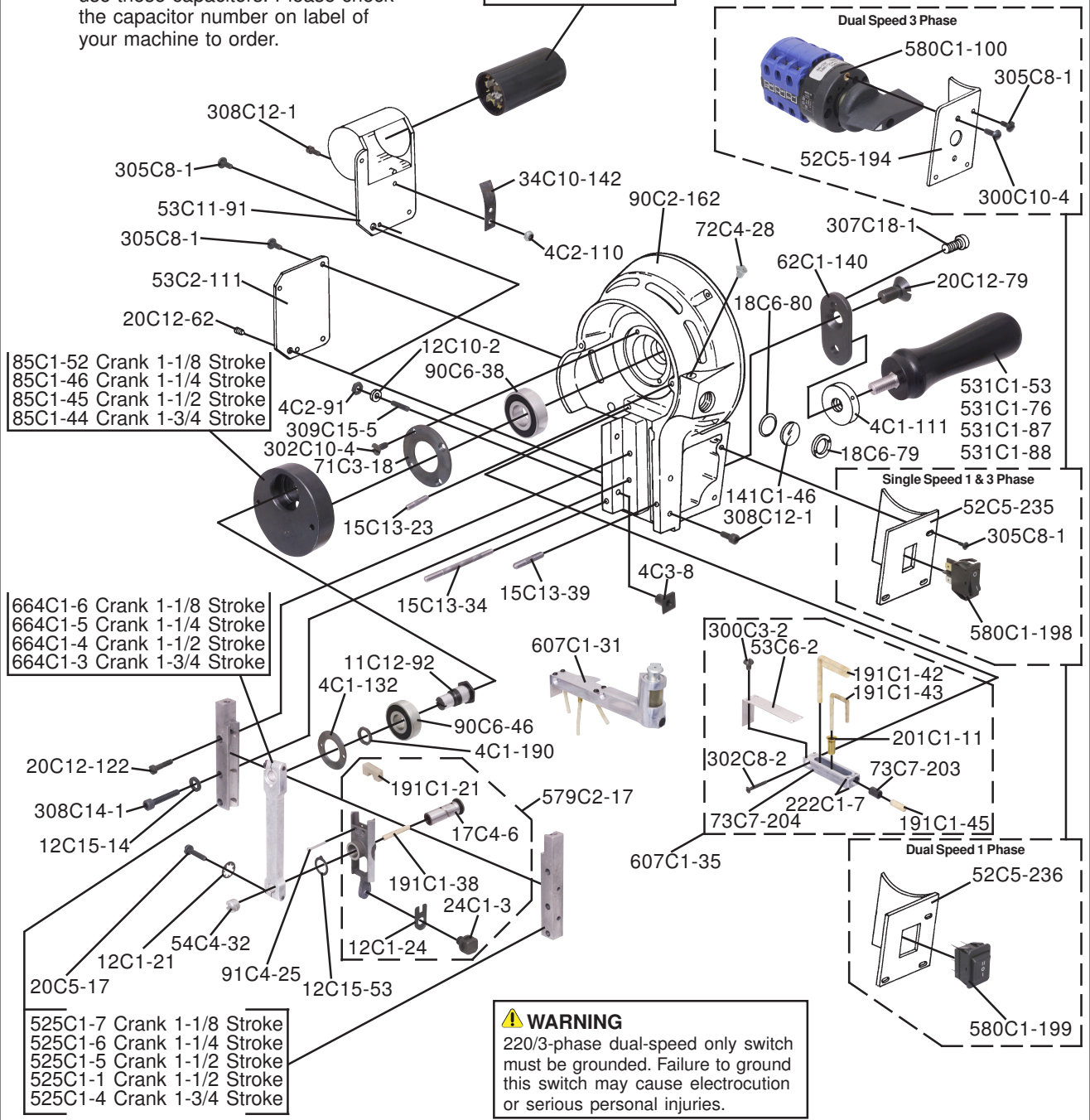

⚠ WARNING
220/3-phase dual-speed only switch must be grounded. Failure to ground this switch may cause electrocution or serious personal injuries.

Notes: L.H. indicates left-hand thread. All others are right-hand.

Slip large lug over switch before replacing switch base. Secure switch to base tightly to ensure positive ground.

All Drawings © 1988-1990, 1993, 1995, 1996, 1998 Eastman Machine Company