

"Genuine" Parts For Eastman Straight Knives

Model 627X BRUTE Model 629X BLUE STREAK II

LOWER GEAR BRACKET ASSEMBLY

Complete Sharpener Assembly Numbers: 637C10-*

		Machine Stroke			
		1-1/8"	1-1/4"	1-1/2"	1-3/4"
Height of Machine	5"	-20	-21	-22	-23
	6"	-24	-25	-26	-27
	7"	-28	-29	-30	-31
	8"	-32	-33	-34	-35
	9"	-36	-37	-38	-39
	10"	-40	-41	-42	-43
	11-1/2"	-	-45	-46	-47
13"	-48	-49	-50	-51	

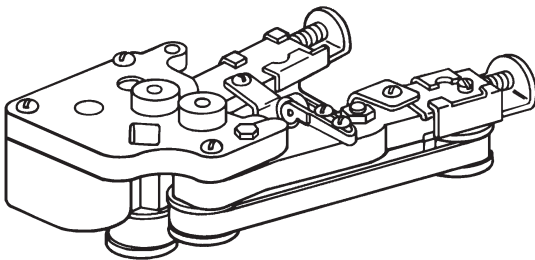

Univ. Number	Eastman Number	Description
GE1491	4C1-189	Jam Nut (8-32)
GE1561	4C2-63	Nut For Sharpener Shoe Screw (2)
GE1654	12C15-93	Washer, Shoe (4)
GE1489	17C15-106	Roll Pin (For Pulley #152C1-19) (2)
GE1495	20C6-25	Adjusting Screw
	20C12-57	Screw For Sharpener Shoe (Wave Knife Only) (2)
GE1501	20C12-143	Screw For Clamping Arm
GE1657	20C12-153	Screw For Sharpener Shoe (2)
GE1761	21C14-14	Bushing For Sharpener Shoe (2)
GE1504	34C10-45	Spring For Pulley Slide (2)
GE1508	34C10-47	Spring For LH Shoe (Wave Knife Only)
GE1554	34C10-57	Spring For RH Shoe (Wave Knife Only)
GE1499	34C10-123	Spring For Arm
GE1762	34C10-148	Spring For LH Sharpener Shoe
GE1763	34C10-149	Spring For RH Sharpener Shoe
GE1500	35C7-28	Clamping Arm For Shoe
GE1477	53C4-78	Gear Cover
GE1482	54C4-35	Oil Hole Plug
GE1483	62C6-31	Bracket, Lower Gear
GE1498	70C4-32	Guide Back Of Standard
GE1505	79C12-219	Wear Plate (2)
GE1481	87C3-50	Gear On Screw Shaft
GE1480	87C5-13	Intermediate Gear
GE1406	90C4-47	Bearing For Intermediate Gear
GE1485	90C4-51	Bearing For Screw Shaft
GE1487	90C4-59	Bearing For Shaft Extension (2)
GE1494	147C1-28	RH Shaft Extension
GE1493	147C1-29	LH Shaft Extension
GE1488	152C1-19	Front Pulley For Belt (2)
GE1490	209C1	Neoprene Band For Pulley (2)
GE1478	300C7-3	Round Head Screw (4-36 x 1/4") (4)
GE1497	300C10-2	Round Head Screw (6-32 x 1/4") (2)
GE1476	300C10-6	Round Head Screw (6-32 x 1/2") (3)
GE1764	301C7-2	Fillister Head Screw (4-36 x 3/16") (2)
GE1496	301C10-3	Fillister Head Screw (6-32 x 3/8")
	309C12-2	Stop Screw For LH Shoe
GE1503	712C1	RH Slide w/Pulley
GE1502	712C1-1	LH Slide w/Pulley
GE1484	715C1-19	Lower Gear Bracket w/Cover, Bearings, Screws & Wear Plate (5"—13" Knives)
GE1919	715C1-23	Lower Gear Bracket, Complete
GE1479	728C1-5	Stabilizer Assembly (2)
GE1540	743C1-26	RH Shoe (Wave Knife Only)
GE1507	743C1-27	LH Shoe (Wave Knife Only)
GE1765	743C1-28	RH Pre-Set Sharpener Shoe Only
GE1766	743C1-29	LH Pre-Set Sharpener Shoe Only
GE1492	820C1-7	LH Complete Shoe Assembly
GE1506	820C1-8	RH Complete Shoe Assembly

Note: Number in parenthesis indicate quantity of a part required.

All Drawings © 1988-1990, 1993, 1995, 1996, 1998 Eastman Machine Company

"Genuine" Parts For Eastman Straight Knives

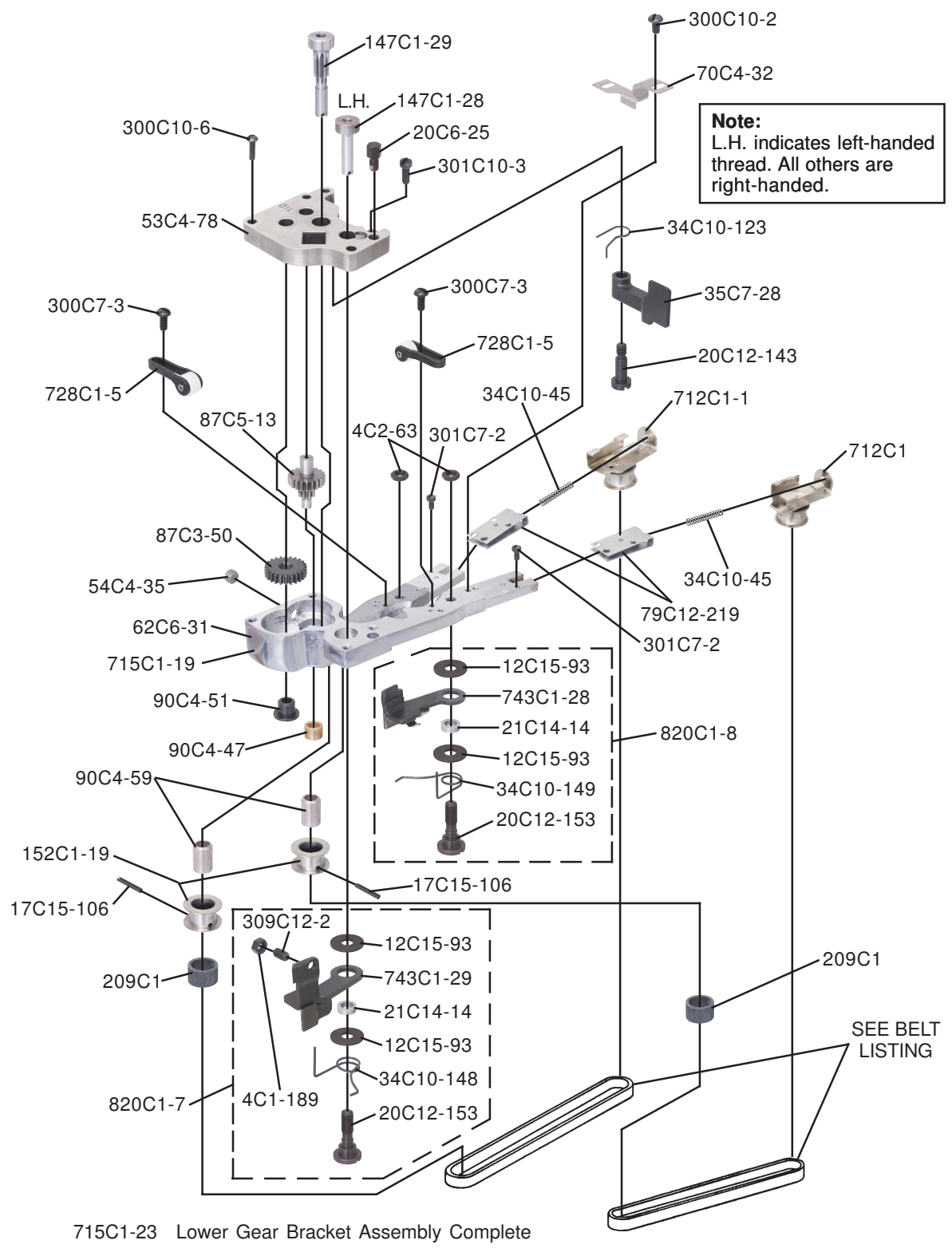

Wave knives require special shoes & related parts listed below.

Univ. Number	Eastman Number	Description	Univ. Number	Eastman Number	Description
GE1507	743C1-27	L.H. Shoe	GE1540	743C1-26	R.H. Shoe
GE1508	34C10-47	L.H. Spring	GE1554	34C10-57	R.H. Spring
GE1501	20C12-143	Screw For Shoe		20C12-57	Screw For Shoe

When using these Special Shoes the following parts must be removed from the Lower Gear Bracket.

Univ. Number	Eastman Number	Description
GE1500	35C7-28	Clamping Arm
GE1499	34C10-123	Spring
GE1501	20C12-143	Screw

All Drawings © 1988-1990, 1993, 1995, 1996, 1998 Eastman Machine Company