

"Genuine" Parts For Eastman Straight Knives

Model 627X BRUTE Model 629X BLUE STREAK II

SHARPENER HOUSING ASSEMBLY (Front View)

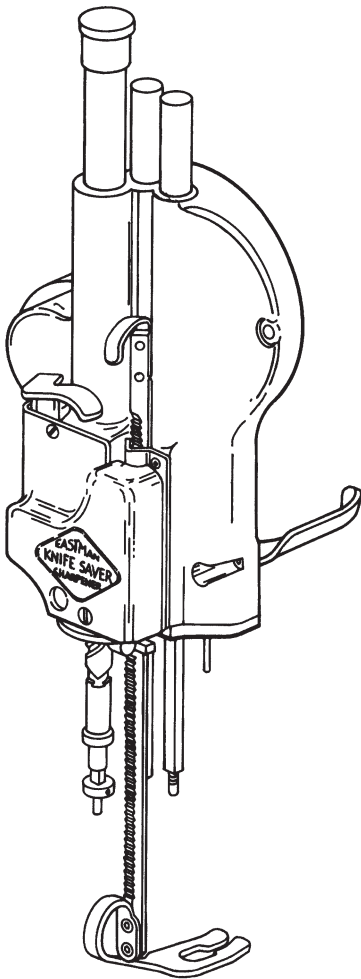

Univ. Number	Eastman Number	Description
GE1735	4C1-149	Nut, Elastic
GE1917	4C1-161	Nut, Self Locking
GE1736	4C2-112	R.H. Nut For Screw Shaft
GE1737	4C2-113	L.H. Nut For Screw Shaft
GE1738	5C5-16	Collar, Lower
GE1408	11C12-54	Shaft For Cam
GE1663	12C15-57	Spring Washer For Release Lever
GE1912	12C15-69	Washer For Lock Bracket
GE1739	12C15-74	Washer, Flat (4)
GE1740	12C15-91	Thrust Washer, Upper Nut (2)
GE1489	17C15-106	Roll Pin For Collar
GE1414	20C4-17	Pressure Foot Lever Screw
GE1412	20C12-13	Cam Shaft Spring Screw
GE1404	20C12-113	Screw For Latch
GE1416	20C12-117	Screw For Pressure Foot Shoe (2)
GE1741	20C12-156	Screw For Release Lever
GE1906	20C12-137	Screw For Knife Guard Lock
GE1742	22C3-2	Lift Handle For Knife Guard Lock
GE1411	34C1-20	Tension Spring
GE1833	34C8-12	Spring For Pressure Foot Lock
GE1413	34C10-179	Spring For Pressure Foot Lever
GE1403	34C10-107	Spring For Latch
GE1743	53C11-72	Cover For Cam
	53C11-103	Vinyl Cover For Handle
GE1407	55C4-49	Spacer For Knife Guard Lock Bracket
GE1417	68C1-192	Pressure Foot Shoe (All Strokes)
GE1744	71C3-15	Thrust Ball Bearing (3)
GE1745	86C7-34	Cap For Tube
GE1406	90C4-47	Bearing For Cam Shaft
GE1397	97C3-35	Latch For Cam
GE1746	147C1-26	Extension For Screw Shaft
GE1916	171C1-16	Lock (Only) For Pressure Foot
GE1453	300C10-1	Round Head Screw (6-32 x 3/16") (2)
GE1415	300C10-4	Round Head Screw (6-32 x 3/8") (4)
GE1661	302C10-4	Flat Head Screw (6-32 x 5/16")
GE1747	302C10-8	Flat Head Screw (6-32 x 3/4")
	309C15-7	Set Screw For Cam
GE1410	553C1-7	Pressure Foot Lock Bracket, Complete
GE1920	553C1-8	Knife Guard Lock Bracket Only
GE1399	605C1-36	Knife Guard Rod (7-8" Knife)
GE1400	605C1-37	Knife Guard Rod (9-10" Knife)
GE1401	605C1-33	Knife Guard Rod (11-1/2" Knife)
GE1402	605C1-34	Knife Guard Rod (13" Knife)
GE1396	621C1-7	Release Lever w/Cam
GE1409	683C1-17	Pressure Foot Lever
GE1392	713C4-4	Screw Shaft w/Extension (R & L Hand Nuts (5"-8" Knife))
GE1393	713C4-5	Screw Shaft w/Extension (R & L Hand Nuts (9"-10" Knife))
GE1241	713C4-6	Screw Shaft w/Extension (R & L Hand Nuts (11-1/2" Knife))
	713C4-7	Screw Shaft w/Extension (R & L Hand Nuts (13" Knife))
GE1749	732C1-11	Sharpener Housing w/Bushings & Tubes Only (5-8" Knife)
GE1750	732C1-12	Sharpener Housing w/Bushings & Tubes Only (9-10" Knife)
	732C1-17	Sharpener Housing w/Bushings & Tubes Only (13" Knife)

Note: Number in parenthesis indicate quantity of a part required.

All Drawings © 1988-1990, 1993, 1995, 1996, 1998 Eastman Machine Company

"Genuine" Parts For Eastman Straight Knives

* THESE PARTS SOLD ONLY IN ASSEMBLIES AS FOLLOWS

- 713C4-4 Screw Shaft with Extension, R. & L. Hand Nuts 5"-8"
- 713C4-5 Screw Shaft with Extension, R. & L. Hand Nuts 9"-10"
- 713C4-6 Screw Shaft with Extension, R. & L. Hand Nuts 11-1/2"
- 713C4-7 Screw Shaft with Extension, R. & L. Hand Nuts 13"

For Spacer Chart (See Sharpener Housing Assembly Drawing) (Rear View)

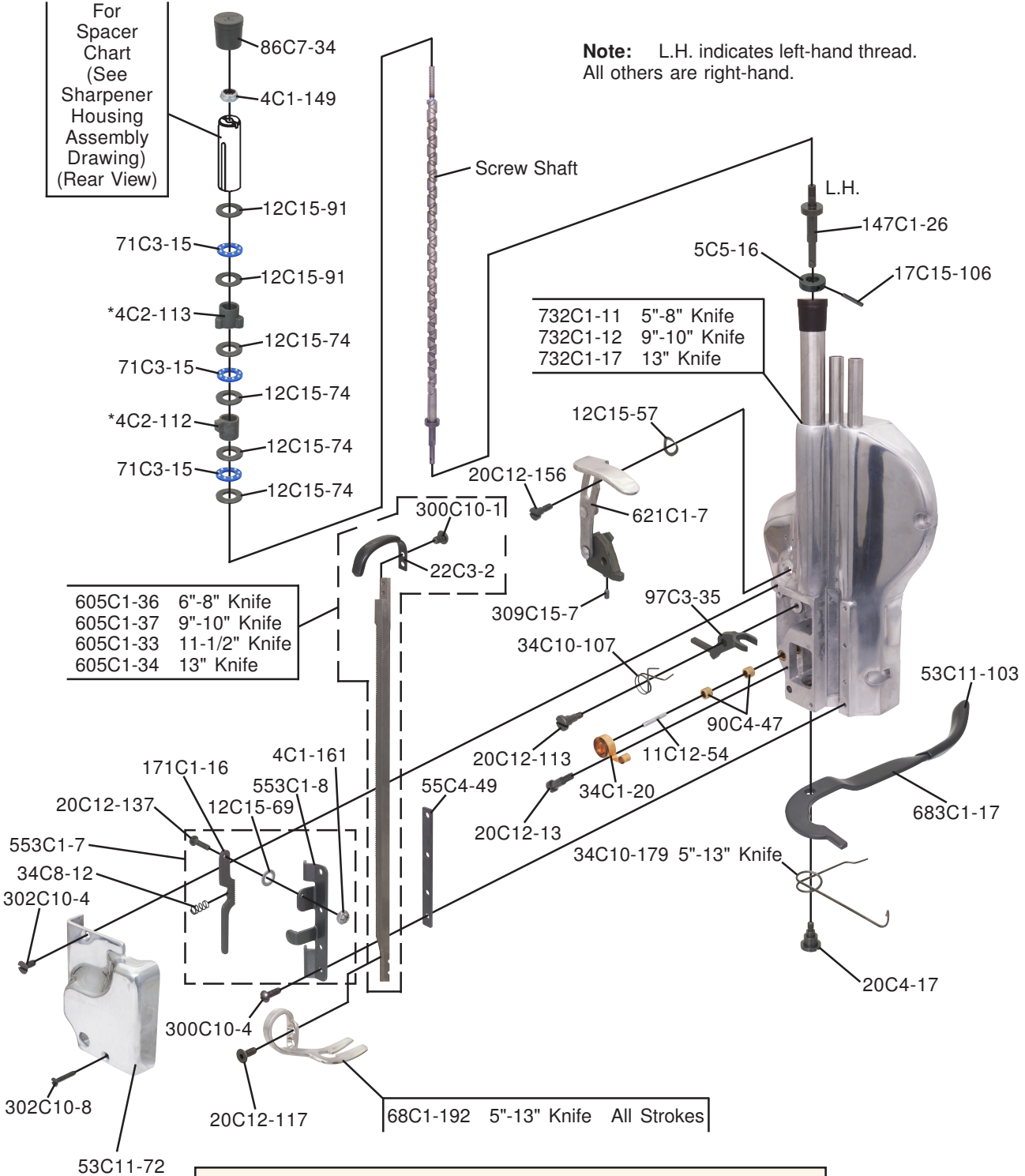

Note: L.H. indicates left-hand thread. All others are right-hand.

- 605C1-36 6"-8" Knife
- 605C1-37 9"-10" Knife
- 605C1-33 11-1/2" Knife
- 605C1-34 13" Knife

- 732C1-11 5"-8" Knife
- 732C1-12 9"-10" Knife
- 732C1-17 13" Knife

- 68C1-192 5"-13" Knife All Strokes

All Drawings © 1988-1990, 1993, 1995, 1996, 1998 Eastman Machine Company