

# "Genuine" Parts For Eastman Round Knives

## Model BBB32

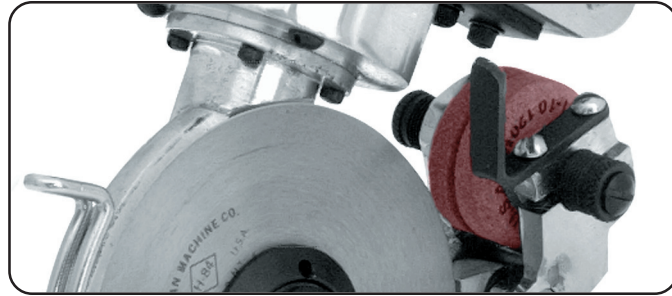

Univ. Number	Eastman Number	Description
	4C1-115	Handle Lock Nut
	4C1-177	Knife Lock Nut
	4C2-101	Wire Nut (2)
	11C2-29	Rear Roller Shaft
	11C2-30	Front Roller Shaft (2)
	11C10-13	Sharpener Shaft
	11C12-105	Knife Gear Shaft
	12C1-22	Washer Shake Proof (2)
<b>GE1594</b>	12C1-28	Lock Washer (2)
	12C2-10	Felt Washer For Stand
<b>GE1755</b>	12C11-74	Spacing Washer
<b>GE1462</b>	12C15-29	Flat Washer
<b>GE1595</b>	12C15-70	Paper Washer
	12C15-100	Washer For Worm Gear Shaft
	17C15-40	Pin For Standard
	18C6-35	Retaining Ring
<b>GE1584</b>	20C6-11	Wheel Adjusting Screw (2)
<b>GE1412</b>	20C12-13	Sharpener Spring Screw
	20C12-165	Thrust Screw
<b>GE1593</b>	20C13-20	Screw For Sharpener
	25C4-106	Knife Guard
	29C6-149	Motor Adapter
	29C6-150	Oil Cup Adapter
	29C6-158	Terminal Block Adapter

Univ. Number	Eastman Number	Description
<b>GE1411</b>	34C1-20	Sharpener Spring
<b>GE1647</b>	34C1-58	Brush Spring (2)
<b>GE1646</b>	36C1-13	Brush (2)
<b>GE1482</b>	54C4-35	Grease Plug
<b>GE1649</b>	54C4-43	Brush Plug (2)
	55C4-98	Spacer Bearing
	57C2-15	Sharpener Lever
	61C1-24	Plate Roller Shell
	62C1-161	Handle Bracket
	72C4-2	Oil Cup
	76C2-34	Plate Filler
	79C5-249	Throat Plate
<b>GE1332</b>	80C1-84	Carbon Round Knife (3-1/4" Dia.)
<b>GE1333</b>	80C1-84	H. S. S. Round Knife (3-1/4" Dia.)
	90C1-140	Bearing Housing (Rear)
	90C2-133	Bearing Housing (Front)
	90C6-40	Ball Bearing, Worm Shaft
<b>GE1596</b>	92C1-12	Spindle
	95C1-21	Wrench
	98C4-32	On/Off Clip
<b>GE1664</b>	151C1-3	Coupling Motor
<b>GE1648</b>	201C1-7	Brass Eyelet (2)
<b>GE1453</b>	300C10-1	Rd. Head Screw (6-32 x 3/16") (2)
<b>GE1415</b>	300C10-4	Round Head Screw (6-32 x 3/8") (4)
	300C10-8	Round Head Screw (6-32 x 3/4") (3)
	300C10-11	Rd. Head Screw (6-32 x 11/16") (3)
	301C7-4	Fil. Head Screw (4-36 x 5/16") (4)
	301C10-1	Fillister Head Screw (6-32 x 1/4")
<b>GE1661</b>	302C10-4	Flat Head Screw (6-32 x 5/16") (2)
	302C15-7	Flat Head Screw (10-32 x 1") (2)
	302C7-2	Flat Head Screw (4-36 x 1/4") (2)
	304C10-1	Truss Head Screw (6-32 x 1/8") (4)
<b>GE1583</b>	304C10-3	Truss Head Screw (6-32 x 1/4") (2)
	308C10-2	S. H. C. Screw (6-32 x 1/2") (2)
	505C2-32	Flat Plate - Roller
	511C1-127	Standard
	517C1-927	Motor (115 Volt)
	517C1-928	Motor (230 Volt)
	524C1-11	Knife Gear
	531C1-52	Handle
<b>GE1824</b>	540C1-36	Emery Wheel Arm w/Wheels
<b>GE1195</b>	541C1-10	Emery Wheel Assembly (2)
	542C1-99	Armature (115 Volt)
	542C1-100	Armature (230 Volt)
<b>GE1425</b>	580C1-48	On/Off Switch
	620C1-22	Emery Wheel Arm
	626C1-36	Switch Base & Bracket Assembly
	653C1-1	Worm Shaft

**Note:** Number in parenthesis indicate quantity of a part required.

# Model BBB32

**TERMINAL BLOCK**  
refer to back cover for  
detailed parts list.

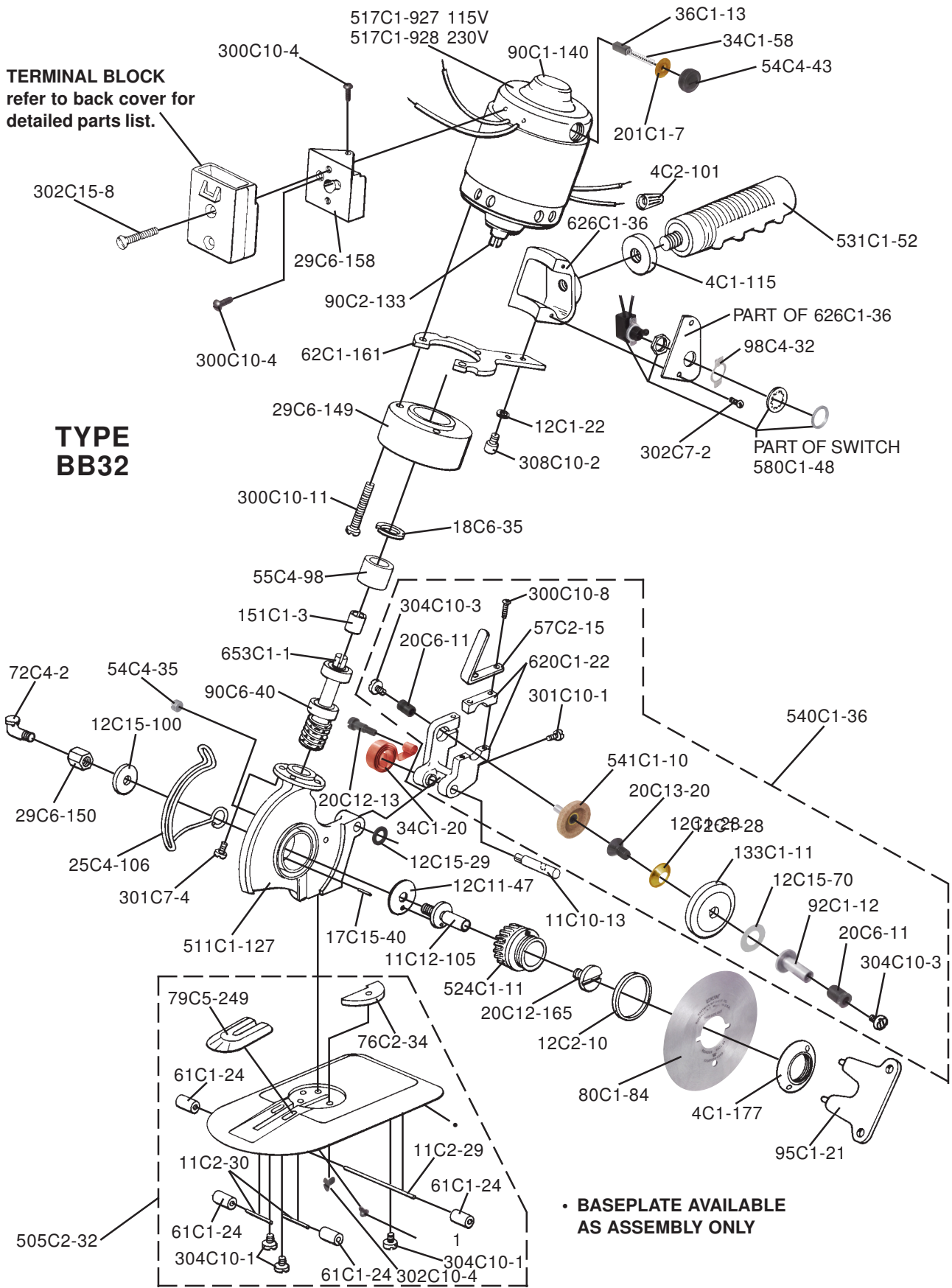

**TYPE  
BB32**

• **BASEPLATE AVAILABLE  
AS ASSEMBLY ONLY**

All Drawings © 1988-1990, 1993, 1995,  
1996, 1998 Eastman Machine Company