

# Parts For Maimin "Mini-Shere"

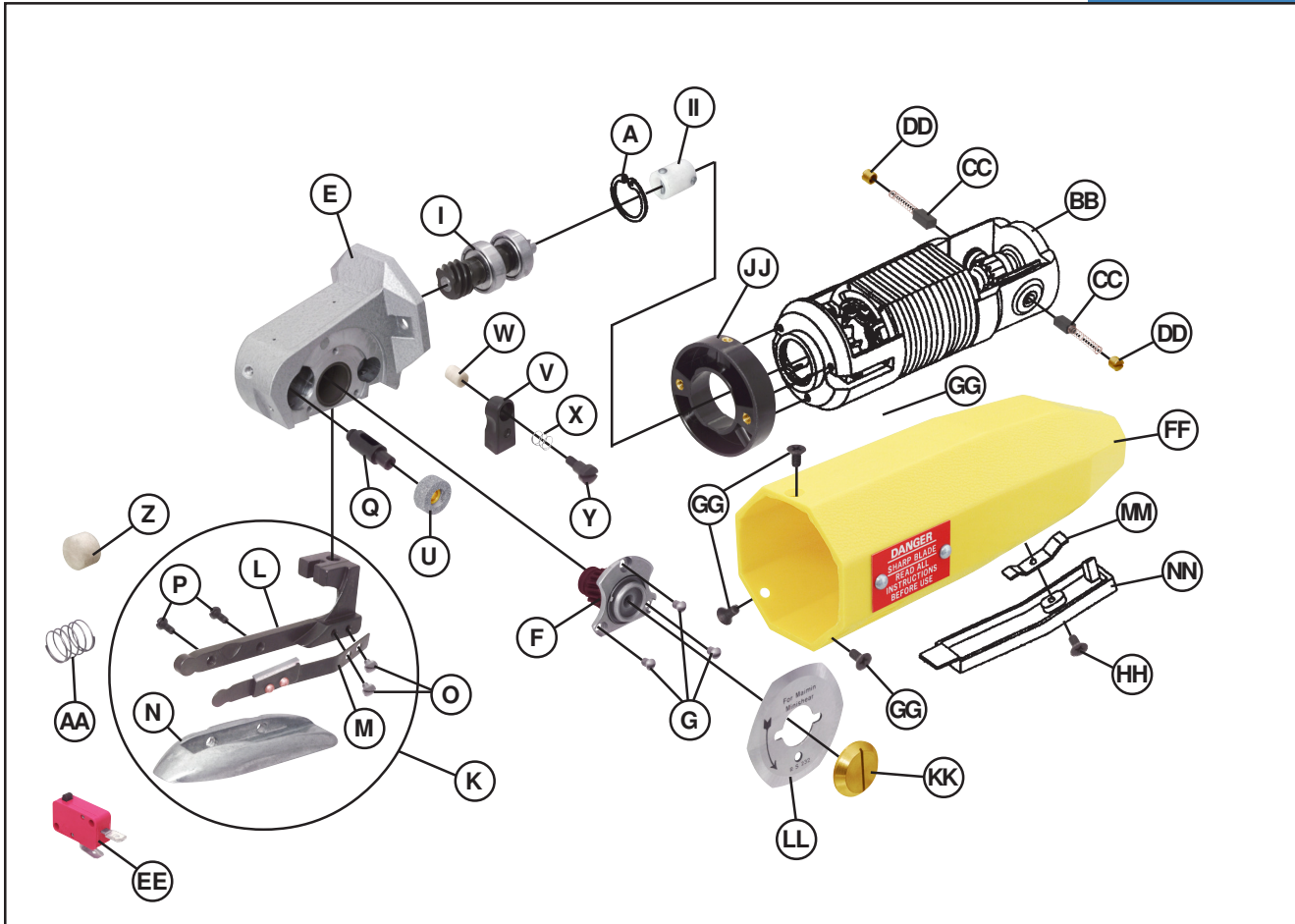

No.	Ref.	Description	Style No.
10301-284	A	Retaining Ring .....	
18254	E	Gear Case .....	#10306
18255	F	Gear Assembly .....	#10310
11095	G	Screws (For Gear Retainer) .....	#10311
18256	H	Gear Retainer .....	#10313
18257	I	Worm Assembly .....	#10320
11104	K	Cutting Guide Assembly .....	#10339
18217	L	Cutting Guide .....	#10340
18218	M	Counter-Cutting Blade .....	#10341
18219	N	Base Plate .....	#10345
18220	O	Pan Head Screw (For Mini-Shere) .....	#10346
10347-284	P	Pan Head Screw (For Mini-Shere) .....	
18258	Q	Sharpener Assembly .....	#10370
18222	U	Sharpening Stone .....	#10378

No.	Ref.	Description	Style No.
18262	V	Front Oiler (Old Style) .....	#10380
18263	W	Front Felt (Old Style) .....	#10381
11300	X	Spring (Old Style) .....	#10382
11106	Y	Shoulder Screw (Old Style) .....	#10383
18264	Z	Rear Felt .....	#10390
11196	AA	Spring .....	#10391
10400-284	BB	Motor Assembly (110 Volt) .....	
10402-284	BB	Motor Assembly (220 Volt) .....	
18223	CC	Carbon Brush .....	#10401
10950	DD	Brush Cap .....	#10413
10872	EE	Switch .....	#10416
10929	FF	Motor Case .....	#10422
11234	GG	Flat Head Screw (M3 X 8) .....	#10423
11234	HH	Flat Head Screw (M3 X 8) .....	#10426
18265	II	Shaft Coupling .....	#10428
11113	JJ	Disc .....	#10429
18267	KK	Knife Lock Screw .....	#10433
GK603	LL	Carbon Steel Blade .....	#RS232 (30312)
11877	LL	Hexagonal Knife (Mini-Shere) .....	#30312
18709	LL	Hexagonal Knife (Mighty-Shear) * .....	#M702
		..... #SP30312 (#16110) (#M700)	
12620	LL	Round Knife (Mighty-Shear) * .....	#M702
10425-284	MM	Spring .....	
10424-284	NN	Switch Lever .....	

\* Denotes Small Slot